

View-A

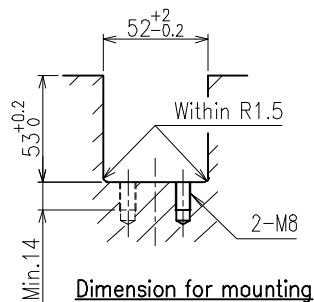

Dimension for mounting

Load capacity			
No. of balls	16		
Supplied air pressure	0.4MPa	0.5MPa	0.6MPa
	{4.08kgf/cm ² }	{5.10kgf/cm ² }	{6.12kgf/cm ² }
Load capacity on each ball	0.98kN	1.24kN	1.51kN
	{100kgf}	{127kgf}	{154kgf}
Load capacity on each unit	15.70kN	19.90kN	24.10kN
	1600kgf	2032kgf	2464kgf

>Description
ISR50D Type Air Ball Lifter
ISR50D-850-A Type
Unit = mm

>Specification
Product weight = 6.8kg
Withstand pressure = 0.9MPa (9.18kgf/cm²)
Working pressure range
= 0.05~0.6MPa (0.51~6.12kgf/cm²)
Operating temperature range
= -5~80°C (without freezing air line)
Using fluid = Air and inert gas (no filling up)

>Material
Ball = SUJ2
Plate = SUJ2
Cap = POM
O-ring = NBR
Grease = Normal Grease
Body = A6063-T5
Plug = A6063-T5
Bar = A6063-T5