

Down

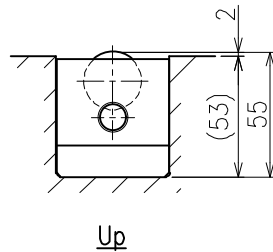

Up

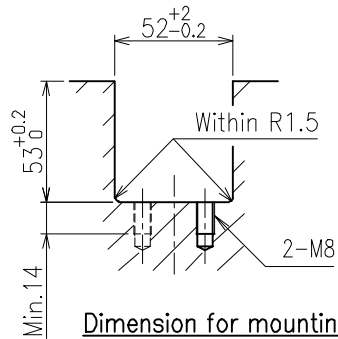

Dimension for mounting

Load capacity			
No. of balls	9		
Supplied air pressure	0.4MPa	0.5MPa	0.6MPa
	{4.08kgf/cm ² }	{5.10kgf/cm ² }	{6.12kgf/cm ² }
Load capacity on each ball	0.98kN	1.24kN	1.51kN
	{100kgf}	{127kgf}	{154kgf}
Load capacity on each unit	8.82kN	11.20kN	13.60kN
	{900kgf}	{1143kgf}	{1386kgf}

>Description

ISR50D Type Air Ball Lifter

ISR50D-500-A Type

Unit = mm

>Specification

Product weight = 4.0kg

Withstand pressure = 0.9MPa (9.18kgf/cm²)

Working pressure range = 0.05~0.6MPa
(0.51~6.12kgf/cm²)

Operating temperature range = -5~80°C
(without freezign air line)

Using fluid = Air and inert gas (no filling up)

>Material

Ball = SUJ2

Plate = SUJ2

Cap = POM

O-ring = NBR

Grease = Normal Grease

Body = A6063-T5

Plug = A6063-T5

Bar = A6063-T5