

Down

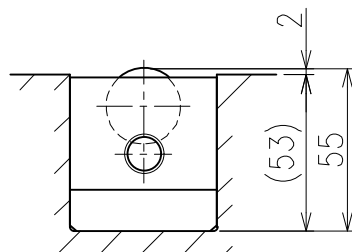

Up

View-A

Load capacity			
No. of balls	2		
Supplied air pressure	0.4MPa	0.5MPa	0.6MPa
	{4.08kgf/cm ² }	{5.10kgf/cm ² }	{6.12kgf/cm ² }
Load capacity on each ball	0.98kN	1.24kN	1.51kN
	{100kgf}	{127kgf}	{154kgf}
Load capacity on each unit	1.96kN	2.49kN	3.02kN
	{200kgf}	{254kgf}	{308kgf}

>Description
 ISR50D Type Air Ball Lifter
 ISR50D-150-A Type
 Unit = mm

>Specification
 Product weight = 1.2kg
 Withstand pressure = 0.9MPa (9.18kgf/cm²)
 Working pressure range = 0.05~0.6MPa
 (0.51~6.12kgf/cm²)

Operating temperature range = -5~80°C
 (without freezing air line)
 Using fluid = Air and inert gas (no filling up)

>Material
 Ball = SUJ2
 Plate = SUJ2
 Cap = POM
 O-ring = NBR
 Grease = Normal Grease
 Body = A6063-T5
 Plug = A6063-T5
 Bar = A6063-T5

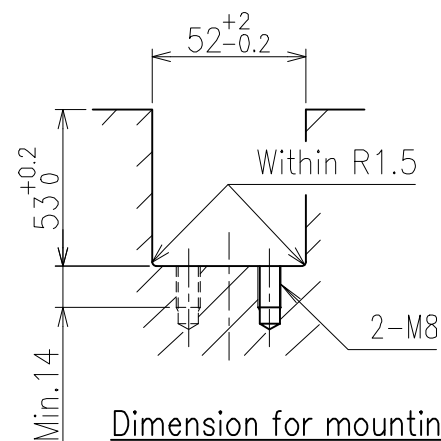

Dimension for mounting